



GX™

The Essential Painting Tool for Professionals



PROVEN QUALITY. LEADING TECHNOLOGY.





The Essential Painting Tool for Professionals

Three reasons why contractors are switching to GX:

- **PERFECT AIRLESS FINISH:** finish more jobs quicker, and with a better finish.
- **EASY TO CARRY AROUND:** take your corded or cordless sprayer wherever you go.
- **EASY PUMP REPLACEMENT:** no tools needed, so no downtime expenses.

A quality airless sprayer has never been this **affordable**.

GX airless sprayers are an essential tool for professionals. The innovative design lets you take your first steps into airless spraying with just a limited investment.

The GX range covers everything from one wall and residential repaints to large finish projects. For both water-based and solvent-resistant materials.

An overview of the different units to help you find the sprayer that best suits your projects.



Model	GX19	GX21	GXFF
Material	Waterbased materials	Water- and solvent based materials	Water- and solvent based materials
Application	Ideal for interior walls and ceilings	For professional residential repaint, new builds and small fine finish jobs	Medium to large fine finish projects
Power source	Corded	Corded or cordless	Corded or cordless

GX™ 19

ProX stainless steel piston pump

Exceptional durability and long life piston pump

Professional SG3™ Gun

With RAC X™ LP517 SwitchTip and Guard, 15 m hose

Direct Immersion design

Draws paint directly from paint buckets



A Push Prime button
Push-Prime button loosens stuck inlet check valve in case of priming issues

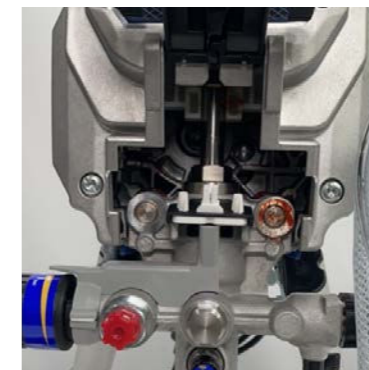

B ProXchange Pump replacement
Fast and easy on-the-job



C Compact design
Lighter than any competitive system

GX™ | Corded or Cordless, You Choose!

GX™ 21•

•• Flexible Clear Tubing

Easy to use and clean. Spray water or solvent-based paints directly from containers from 1 - 30 litres.



•• Convenient Drip Cup

Eliminates the risk of paint drips.



D •• Direct Immersion Design

Draws paint directly from paint buckets.

A B C Features - see p.6



•• Professional SG3™ Gun

With 2 RAC X™ tips, 15 m hose



•• ProX™ Power-Piston Pump

- Exceptional durability and long life piston pump
- Exclusive, lifetime lubricated wiper pad for maintenance-free operation
- Modular pump components for easy maintenance

GX™ 21 CORDLESS



• Powered by DeWALT™

Spray up to 11.5 litres per battery charge



- Corded and Cordless
- Cordless specific

GX™ | Corded or Cordless, You Choose!

GX™ FF



Hopper (5.7 litre) – Toolless removal

Ideal for small amounts of material
Lid included for spill-proof portability

Durable FTx™-E Gun

with RAC X™ tip, 7.5 m hose



CONTRACTOR PC COMPACT GUN: SPRAY IN THE TIGHTEST AREAS WITH EASE

The Contractor PC Compact, 25% lighter and 25% smaller, delivering all-day comfort and control — designed for maximum flexibility in tight spaces. Reduce downtime 1-part, on-the-job gun rebuild.

GX™ FF Cordless

Powerful Brushless DC motor

Lightweight, compact design allows for increased portability
Powerful brushless motor provides extended runtime



Powered by DeWALT™

Spray up to a full day of fine finish projects with two fully charged DEWALT batteries



A B C



A Adjustable Pressure Control

Allows you to spray or roll a wide range of coatings.

B PushPrime™

Assures fast priming every time — loosens stuck inlet check valves in case of priming issues.

C Pressure Gauge

Professional oil-filled pressure gauge

Technical Specifications

All units ship complete and ready to spray:



Model Name:	GX™ 19	GX™ 21	GX™ 21 cordless	GX™ FF	GX™ FF cordless
Part Numbers:					
for EURO Version (230 V)	CEE / 18H284	CEE / 17G183	CEE cordless / 25T967	CEE VDO cord / 17G184	CEE cordless / 25U466
for Multicord Version (230 V)	UK cord / 18H285	Multi : IT-CH-DK-UK / 17H218	UK cordless / 25T973	Multi x4: IT-CH-DK-UK / 17H222	UK cordless / 25U570
Max. Working Pressure - bar	207 bar	207 bar	207 bar	207 bar	207 bar
Max. Tip Size - 1 Gun	0.019"	0.021"	0.021"	0.019"	0.019"
Max. Fluid Flow - lpm / (gpm)	1.4 / (0.37)	1.8 / (0.47)	1.8 / (0.47)	1.4 / (0.37)	1.4 / (0.37)
Frame Design	DI Stand	DI Stand	DI Stand	Hopper Stand	Hopper Stand
Suction System	Suction tube	Suction tube, solvent resistant	Suction tube, solvent resistant	5.7 litre Hopper, solvent resistant	5.7 litre Hopper, solvent resistant
InstaClean™ Pump Filter	40 mesh	40 mesh	40 mesh	None	None
Hose	1/4" x 15 m Duraflex™	1/4" x 15 m Duraflex™	1/4" x 15 m Duraflex™	3/16" x 7.5 m BlueMax™ II	3/16" x 7.5 m BlueMax™ II
Power supply	Power cable	Power cable	2x 54V DeWALT™ FlexVolt 6.0 Ah battery	Power cable	2x 54V DeWALT™ FlexVolt 6.0 Ah battery
Gun / Guard / Tip	SG3™ / RAC X™ / LP517	SG3™ / RAC X™ / LP517 / FFLP310	SG3™ / RAC X™ / LP517 / FFLP310	FTx™ -E / RAC X™ / FFLP210	Contractor PC Compact / RAC X™ / FFLP210
Gun Filter	60 mesh	60 mesh	60 mesh	100 mesh	100 mesh
Gun Style	4-Finger	4-Finger	4-Finger	2-Finger	2-Finger



Transform your GX unit into the optimal renovation painting tool

JETROLLER™

Extend your sprayer

Use your preferred roller and combine rolling & spraying into one operation. Extend your sprayer with the JetRoller and minimize application time when combining rolling and spraying into one operation.

Benefits:

- Uses commonly available 18 or 25 cm roller covers.
- Completes large jobs in half the time of traditional methods
- Reduces overspray
- Eliminates reaching
- Eliminates climbing and continually reaching up and down

Kit includes a lightweight detachable roller frame, 50 cm extension, CleanShot™ Shut-Off™ valve, Inline™ gun, spray tip and guard.



PROXCHANGE™ PUMP REPLACEMENT SYSTEM



The Easy & Fast Pump Repair System

In four simple steps, you can remove and replace the pump cartridge:

- No tools needed to remove pump
- Simply lift door to remove pump



Slide & lift open access door



Remove pump section

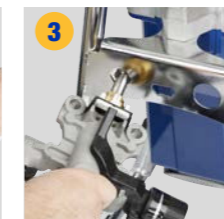

Use frame hex fitting to loosen pump and remove cartridge

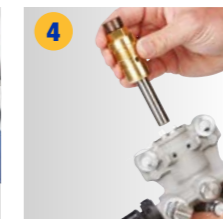

Install new cartridge and replace pump



! TIP

Replacement Pump
Avoid downtime by keeping a spare replacement pump to hand!

Accessories

Get the most out of your equipment,
using our professional accessories:



Guns

17J261	FTx™-E gun, 2-Finger, with RAC X™ 210 tip
17J910	SG3™ gun, 4-Finger, with RAC X™ 515 tip
19Y350	Contractor PC Compact™ gun, with RAC X™ 517 tip



Filters

Gun Filter (for GX™ FF - FTx™-E Gun)

257129	30 mesh, grey	287033	100 mesh, blue
287032	60 mesh, black	257130	200 mesh, red



Gun Filter (for GX™ FF Cordless - Compact™ Gun)

19Y355	60 mesh, black	19Y356	100 mesh, blue
19Y358	60 & 100 mesh, black & blue		



Gun Filter (for GX™ 21 - SG3™ Gun)

218131	50 mesh, blue	256975	150 mesh, red
218133	100 mesh, orange		

Material Filter InstaClean™

257094	40 mesh, inline filter
--------	------------------------



Hoses

214698	3/16" x 7.5 m (BlueMax™ II)
247340	1/4" x 15 m (Duraflex™)



Tips & Guards

LPXXX	Green RAC X™ low pressure tip
FFLPXXX	Green RAC X™ Fine Finish low pressure tip
WA12XX	RAC X™ Wide RAC™, for big surfaces
246215	RAC X™ guard



Other

17J444	Carrying strap
17J244	Hopper, 5.7 litre (GX™ FF only)
253574	Pump Armor™, 1 litre, cleaning fluid



ProXChange™ Pump Kit - Blister Pack

24Y472	Blister pack, fits all GX units
--------	---------------------------------



JetRoller™ System

with Inline™ Gun		without Inline™ Gun	
24V490	roller 18 cm	24V492	roller 18 cm
24V491	roller 25 cm	24V493	roller 25 cm

CleanShot™ RAC X™ Pole Gun

287026	90 cm	287027	180 cm
--------	-------	--------	--------

Rollers with InLine™ Gun

6880095	Exterior, 30 cm fixed
098084	Exterior, 90-180 cm telescopic
098085	Exterior, 45-90 cm telescopic
245397	Interior, 50 cm fixed



RAC X™ Tip Extensions

287019	25 cm	287021	50 cm
287020	40 cm	287022	75 cm
232123	1 m Heavy Duty extension		



Whips (230 bar)

238358	3/16" x 0.9 m
238359	3/16" x 1.8 m
238959	3/16" x 1.4 m



ProGuard™+

24W090	230 V, CEE 7/7, shuko
24W755	230 V, IEC320, multicord



Batteries

20A163	DeWalt™ 54V 6.0 Ah FlexVolt Battery
20A166	DeWalt™ Fan-cooled fast charger





OUR BRAND PROMISE TO YOU

Since 1926, **innovation**, **quality** and **A+ Service** have been at the centre of Graco.

Experience Innovation

Our focus on innovation results in products and equipment that lead the industry with technologically-advanced features, pioneering design, high performance and unparalleled reliability. In short, innovation is how you get better products!

Building Quality

You're investing in high-quality products built to last for years of reliable service. Moreover, we partner with our customers to better understand how you're deploying our products in the field, then use your experiences to improve performance and durability.



A+ service, every time

You'll see A+ Service in action when you contact any of our support services options no matter where you are in the world. We'll listen to your situation and work methodically to resolve it as quickly as we can. We are guided by a mindset of integrity and a customer service view centred on collaboration and relationships, not transactions.



We're here to answer questions and help address your needs:

www.graco.com/contact

Graco is certified ISO 9001.

©2016 Graco Distribution BV 300735ENEU-F 09/24 Printed in Europe.

All written and visual data contained in this document are based on the latest product information available at the time of publication. Graco reserves the right to make changes at any time without notice.

All other brand names or marks are used for identification purposes and are trademarks of their respective owners. For more information on Graco's intellectual property, see www.graco.com/patent or www.graco.com/trademarks.